

LOT 73
netto opp.: 56,0 m²
bruto opp.: 66,9 m²

LOT 72
netto opp.: 56,0 m²
bruto opp.: 66,9 m²

LOT 71
netto opp.: 53,6 m²
bruto opp.: 64,5 m²

LOT 70
netto opp.: 56,0 m²
bruto opp.: 66,9 m²

LOT 69
netto opp.: 53,6 m²
bruto opp.: 66,9 m²

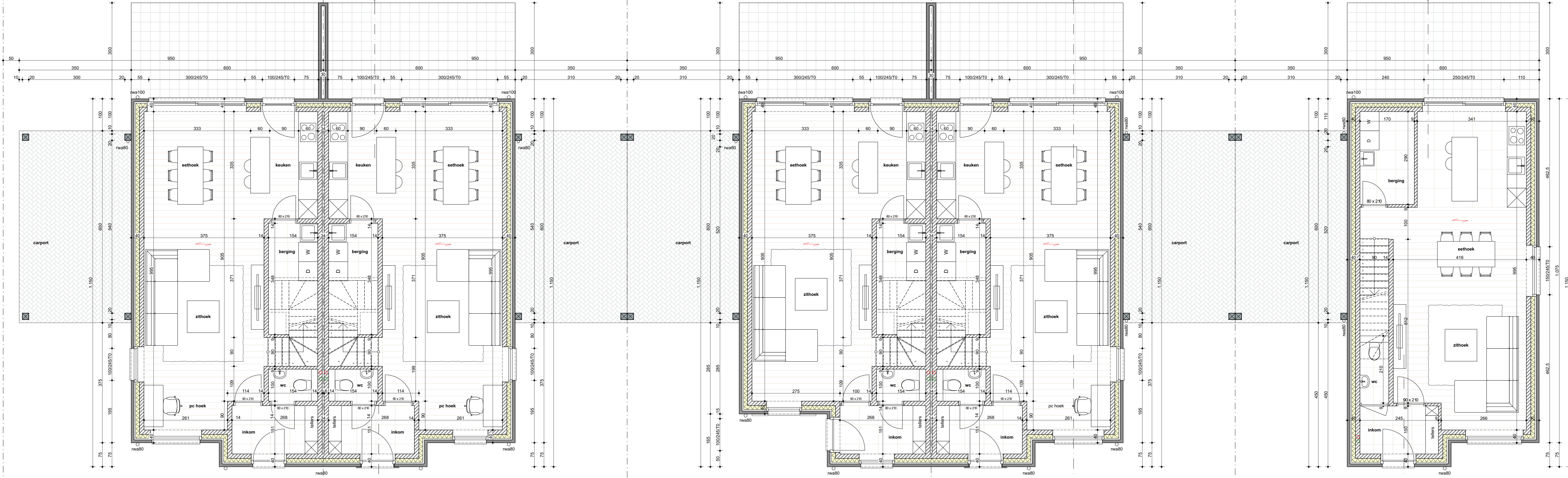

GELIJKVLOERS

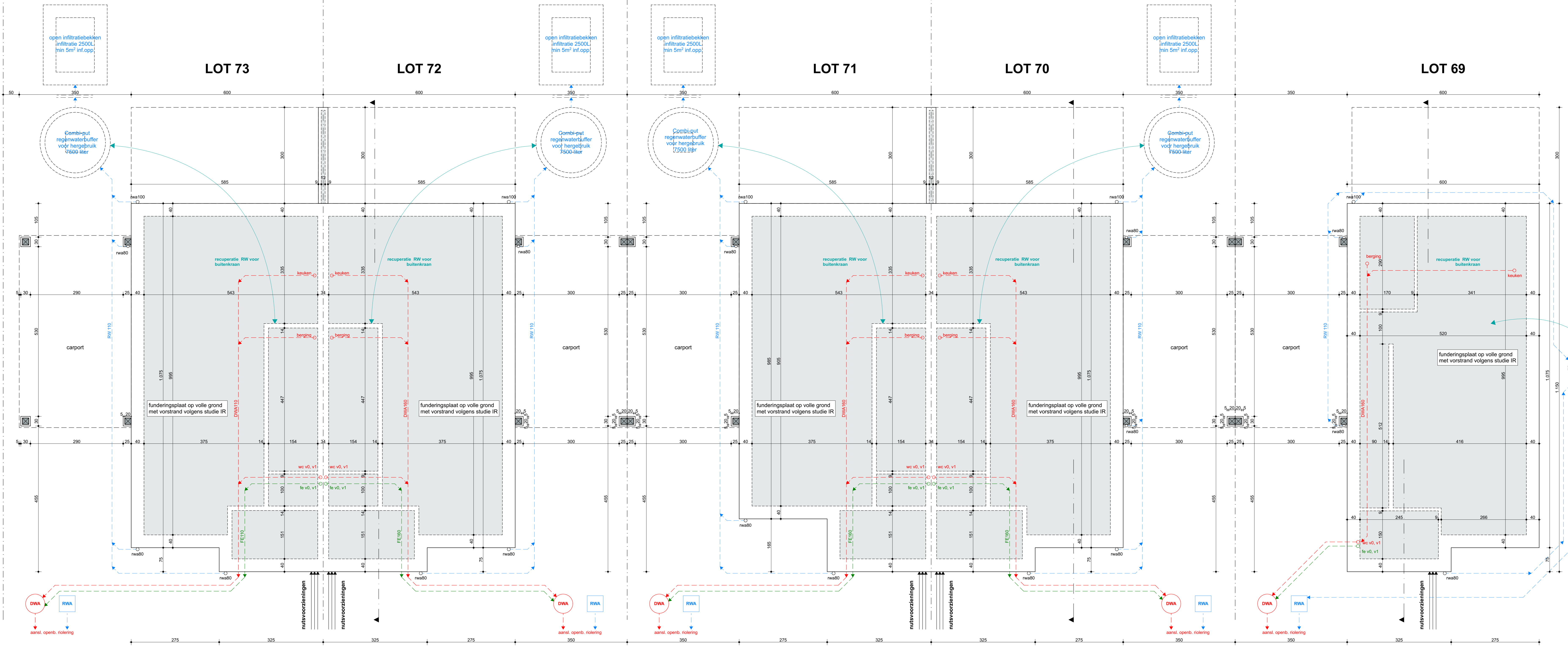

FUNDERING - RIOLERING